



squarefoot.com.hk[®] 揀宅

LAKE COMO ITALY

A ROOM
WITH A
VIEW

50%
DISCOUNT

2 BED APARTMENTS
FROM €375,000

專題報告 special report

Chilling Numbers

A look at the recent cooling measures

樓市冷卻措施

市場焦點 focus

Southern Comfort

Pattaya continues its rebirth with Southpoint

芭堤雅的全新優質項目

立即
下載

Squarefoot.com.hk
iPhone App



Available on the
App Store

DIRECT PROPERTY GROUP



PASSION & PRIDE

FREE

December 1-15 2012 Issue 161



👉 We are a group of new generation professionals and designers working in an interactive studio, we cultivate designs for our clients with innovations and forefront perspectives.

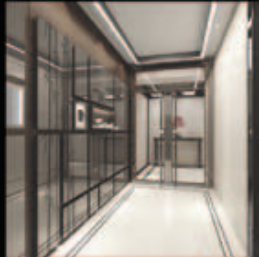

Else design

info@elsedesign.com.hk

Unit B, 19/F EGL Tower
No. 83, Hung To Road
Kwun Tong, Hong Kong

www.elsedesign.com.hk



POSSIBILITIES & CHOICES

tel: (852) 3160 8583

fax: (852) 3160 8577

Club House • Residential • Office • Commerical



Edgar Chan
Design Director

edgarchan@elsedesign.com.hk



Residential Club House – 1,500 msq

University Town, Guangzhou, China

Xiaogouwei Island in Guangzhou's Panyu District is now perhaps best known for being a hub of education. Ten universities have campuses in the area, and as such the island has come to be known as University Town.

The latest addition to the landscape here is University Garden Club House, University Town, Guangzhou, China(大學小築住客會所—中國廣州大學城), which also features a 16,000-square foot residential clubhouse spanning three levels with a sweeping rotunda space connecting the ground and first floors. A fusion of traditional Chinese and modern materials, the prominent textures — clay brick, slick mirror, stainless steel — evoke a unique sensation of both contemporary and Asian charm. Among the facilities in the clubhouse are a mini-cinema, a billiards room, a table tennis room, fitness centre, a children's room, a yoga studio and a painting room.

Hong Kong-based Else Design, which has a broad portfolio in China and Southeast Asia and wealth of experience in attempting to marry modern space demands with a community-oriented living environments, designed the clubhouse. It was suggested to the client that if the original architectural design — which placed the dominating staircase at the entrance lobby — was relocated to the central rotunda it would create a centripetal spatial arrangement that would take advantage of the 270-degree view of the surrounding scenery through the structure's rounded glazed façade. The metallic sculptural chandelier above the stairs becomes the project's second focal point for its constantly changing reflections, whose images come from both artificial and natural surroundings. 

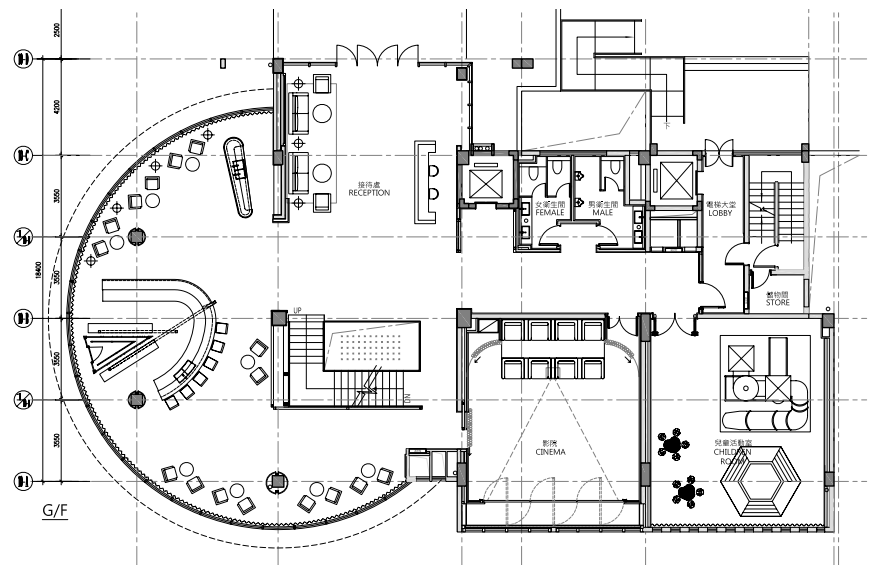

Edgar Chan
Design Director

info

Else Design
+852 3160 8583
info@elsedesign.com.hk
www.elsedesign.com.hk